

- > Your User Manual is the BlueDriver App under More > User Manual.
- > Your new BlueDriver gives you unlimited access to vehicle data, now and down the road!

**24/7 First class customer support here for you!**

In-App Chat      More > Contact Us > Live Chat  
 Web                    support.bluedriver.com  
 Email                 support@bluedriver.com  
 Phone                 1-866-302-0054

# BlueDriver®

Quick Start Guide

Please download the BlueDriver App and  
**review setup instructions inside!**



## Let's get scanning!

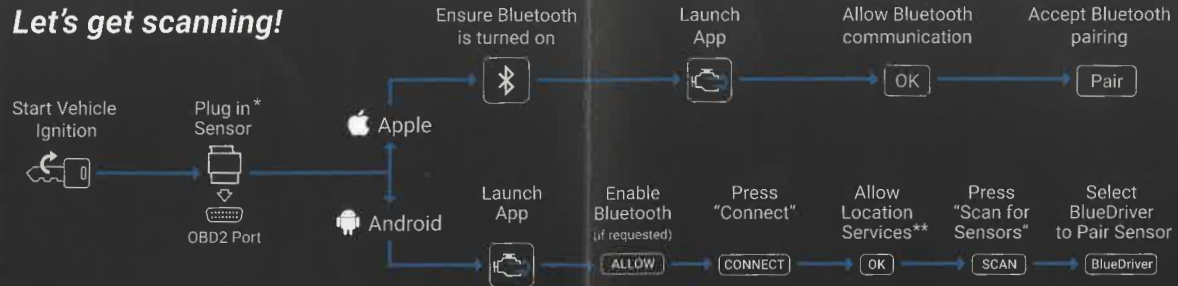

**Note:** Your BlueDriver uses Bluetooth LE, so you pair it from **within the BlueDriver app**.

\* OBD2 port is usually located underneath the driver side dash, or center console.  
 \*\* BlueDriver does not access location data. Required for in app pairing. You can also pair from the device settings if you would prefer not to turn on location services.